

# Mobile Bowl Stand

## Stainless Steel

**Models****712, 713**

Model 713



Model 712

### Add Mobility And Flexibility To Bulk Food Preparation

**Benefits**

- Mobility allows stand to be moved to the worksite or storage
- All-welded stainless steel construction is easy to clean and sanitize

**Features**

- Top cutout accepts 30-quart (#712) or 80-quart (#713) bowl (not included)
- Lower shelf provides handy storage for supplies and ingredients

**Casters**

- Heavy-duty 4" stem-mount casters, two with brake

**Specifications:**

Shall be Lakeside Model #712 or #713 and shall be of welded stainless steel construction. Top shall be of 16-gauge stainless steel and shall have a cutout to accept a round 30-quart (#712) or 80-quart (#713) bowl (not included). Upright legs shall be of 12-gauge angle stainless steel. Unit shall feature 16-gauge undershelf having floor clearance of 9¾" for storage of utensils, supplies and ingredients. Casters shall be 4" diameter all-swivel with non-marking 1" wide wheels. Two casters shall have locking wheel brake. Unit shall be NSF listed.

Spec. # \_\_\_\_\_

AIA # \_\_\_\_\_

Lakeside Manufacturing, Inc.

4900 West Electric Avenue • West Milwaukee, WI 53219 U.S.A.

800-558-8565 • 414-902-6400 • Fax 414-902-6446 • info@elakeside.com • www.eLakesideFoodservice.com

# Mobile Bowl Stands

## Stainless Steel

Spec. #

AIA #

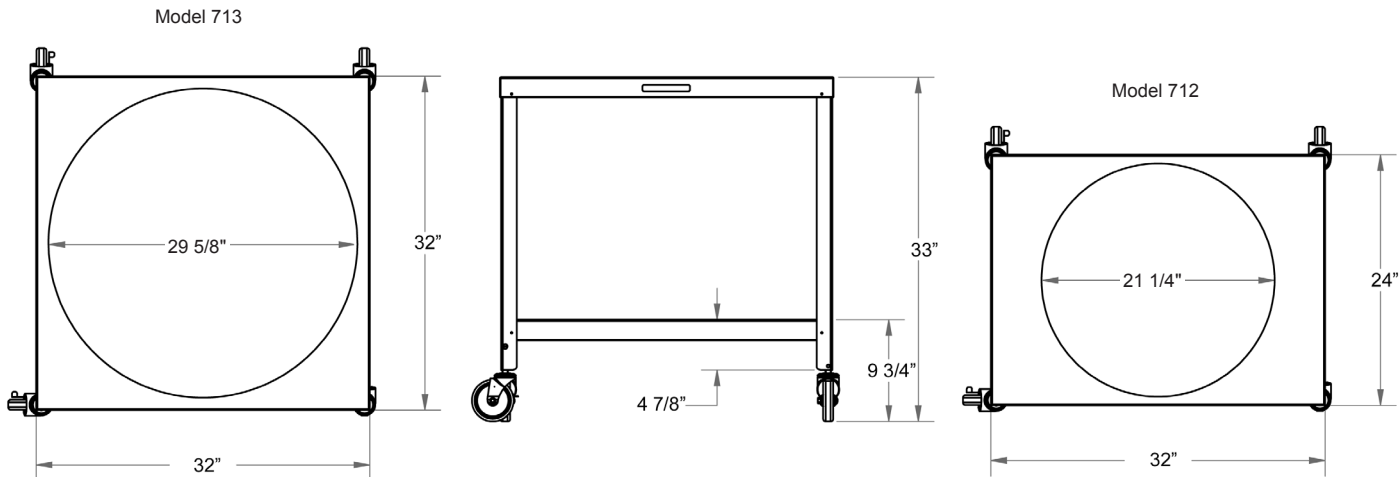

### Dimensions:

Model	Overall Size			Accepts Bowl Size	Bowl Cut-out	Casters		Case Wt. Lbs.
	W	L	H			Type	Dia.	
712	24"	32"	33"	30	21 1/4"	All Swivel	4"	50
	(610)	813	838)	Quart	(540)	2 w/Brake	(102)	(22.7 kg)
713	32"	32"	33"	80	29 5/8"	All Swivel	4"	60
	(813)	813	838)	Quart	(752)	2 w/Brake	(102)	(27.3 kg)

Dimensions in ( ) denote metric milimeters, unless otherwise noted.

### Options:

- ☐ 30-Quart Aluminum Bowl (Model 712)
- ☐ 80-Quart Aluminum Bowl (Model 713)



This product can expose you to wood dust and chemicals including chromium, which are known to the State of California to cause cancer. For more information go to: [www.P65Warnings.ca.gov](http://www.P65Warnings.ca.gov)



Lakeside Manufacturing, Inc.  
4900 West Electric Avenue • West Milwaukee, WI 53219 U.S.A.  
800-558-8565 • 414-902-6400 • Fax 414-902-6446 • [www.eLakeside.com](http://www.eLakeside.com)