

Bussing Stations

Mobile Stainless Steel



Model 4612
(Shown in Hard Rock
Maple finish)



Model 4615

Models

4610, 4612, 4615, 4618

Add Organization And Enhance The Appearance Of Dining Areas

Benefits

- Add attractive service functionality to patios and indoor dining areas
- Easy mobility to provide dining room flexibility

Features

- Stainless steel welded construction
- Sealed disposal receptacle for waste liquids
- Choice of stainless steel or laminate exterior finishes
- Concealed casters provide built-in look
- Open and concealed storage

Casters

- All-swivel 5" cushion tread



**Liquid disposal and
waste chute**



**Sealed 7-gallon waste
liquid receptacle**

Specifications:

Unit is of welded stainless steel construction and has 18-gauge sides and 16-gauge top. Interior compartment floor is 18-gauge stainless steel. Top has 6" high backsplash wall on three sides. Open compartments include three sets of adjustable-height universal ledges to accommodate bus tubs or various trays. Unit top features a refuse chute and drop-in stainless steel drainage sink for liquid waste. Sink drains to a sealed 7-gallon polyethylene waste liquid receptacle. Enclosed compartment includes space for liquid receptacle and waste bin (bin not included). Hinged compartment door has recessed paddle latch. 5" all-swivel casters with cushion tread wheels are recessed/hidden and are fastened to a stainless steel dolly frame for extra strength.

Spec. #

AIA #

Lakeside Manufacturing, Inc.

4900 West Electric Avenue • West Milwaukee, WI 53219 U.S.A.

800-558-8565 • 414-902-6400 • Fax 414-902-6446 • info@eLakeside.com • www.eLakesideFoodservice.com

Models
4610, 4612
4615, 4618

Bussing Stations

Mobile Stainless Steel

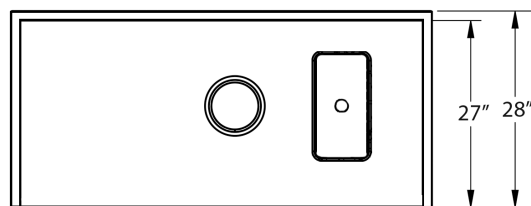

Model 4610

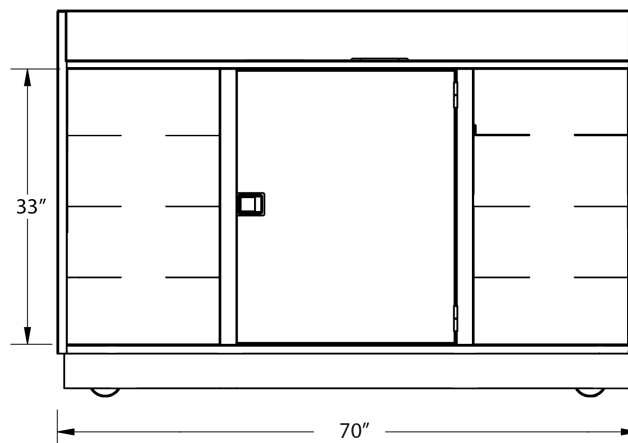
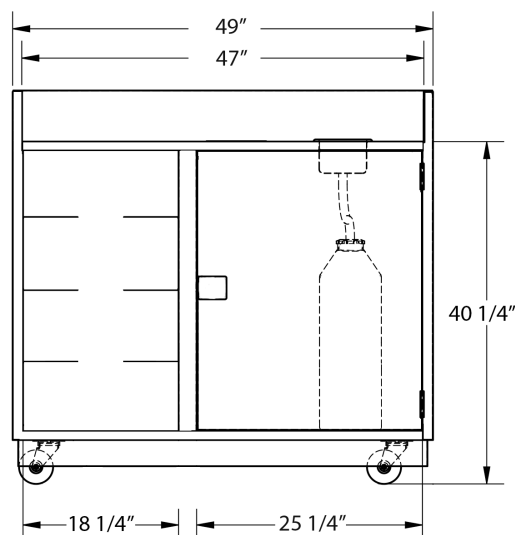

Model 4615

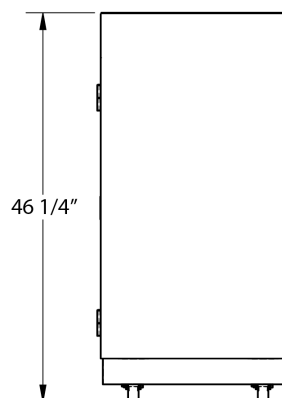

Product Information:

Model	Overall Size			Encl. Compartment			Open Compartment(s)			Exterior Finish	Case Wt. Lbs. (Kg)
	W	D	H	W	D	H	W	D	H		
4610	49" (1245)	28" 711	46 1/4" 1175)	25 1/4" (641)	26 3/4" 679	33" 838)	18 1/4" (464)	26 3/4" 679	33" 838)	Stainless Steel	355 (161)
4612	49" (1245)	28" 711	46 1/4" 1175)	25 1/4" (641)	26 3/4" 679	33" 838)	18 1/4" (464)	26 3/4" 679	33" 838)	Laminate	362 (164)
4615	70" (1778)	28" 711	46 1/4" 1175)	25 1/4" (641)	26 3/4" 679	33" 838)	18 1/4" (464)	26 3/4" 679	33" 838)	Stainless Steel	377 (171)
4618	70" (1778)	28" 711	46 1/4" 1175)	25 1/4" (641)	26 3/4" 679	33" 838)	18 1/4" (464)	26 3/4" 679	33" 838)	Laminate	384 (174)

Dimensions in () denote metric millimeters, unless otherwise noted.

Accessories:

☐ 23-gal.polywastebin (20" x 11" x 30") _____

Available Laminate Finishes



☐ Walnut



☐ Gray Sand

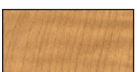

☐ Light Maple



☐ Victorian Cherry



☐ Beige Suede

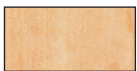

☐ Hard Rock Maple



☐ Red Maple



☐ Red



☐ Green



☐ Black



☐ Royal Blue



☐ Purple

Options:

- ☐ Leveling feet (in place of casters) ☐ Removable shelf (1)
- ☐ 6" wide tread casters* ☐ Removable overshef (half)
- ☐ Plumbed sink with faucet (4615, 4618 only)

* Stainless steel skirt not available with this option.

LAKESIDE
 Ingenuity On Wheels

Lakeside Manufacturing, Inc.
 4900 West Electric Avenue • West Milwaukee, WI 53219 U.S.A.
 800-558-8565 • 414-902-6400 • Fax 414-902-6446
 info@eLakeside.com • www.eLakesideFoodservice.com